

WITHOUT COOLANT (FORM A)

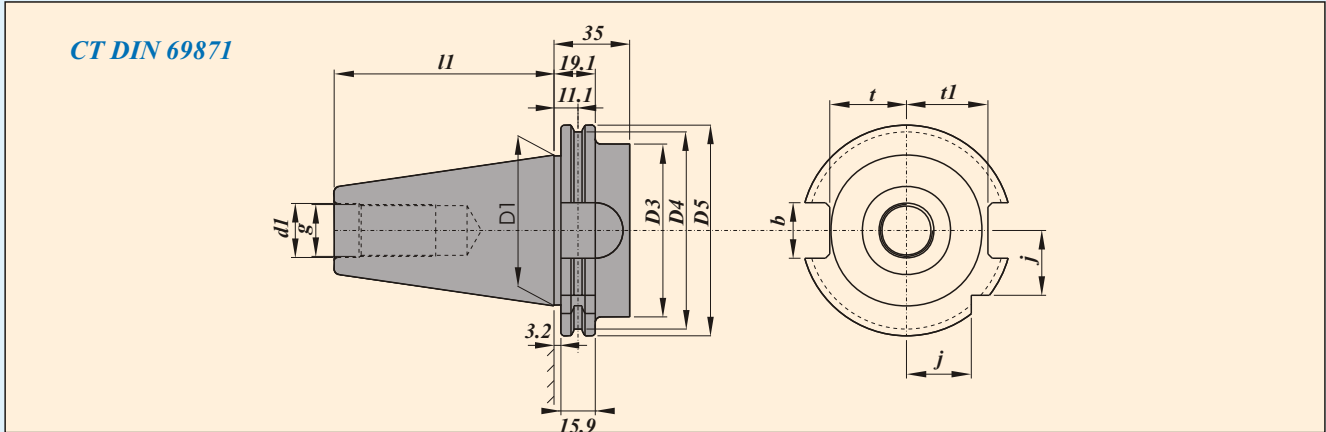

TAPER	D1	D3	D4	D5	l1	g	d1	t	t1	b	j
30	31.75	45	44.3	50	47.8	M 12	13	16.4	19	16.1	15
40	44.45	50	56.25	63.55	68.4	M 16	17	22.8	25	16.1	18.5
45	57.15	63	75.25	82.55	82.7	M 20	21	29.1	31.3	19.3	25
50	69.85	80	91.25	97.5	101.75	M 24	25	35.5	37.7	25.7	30

WITH COOLANT THROUGH CENTER (FORM AD)

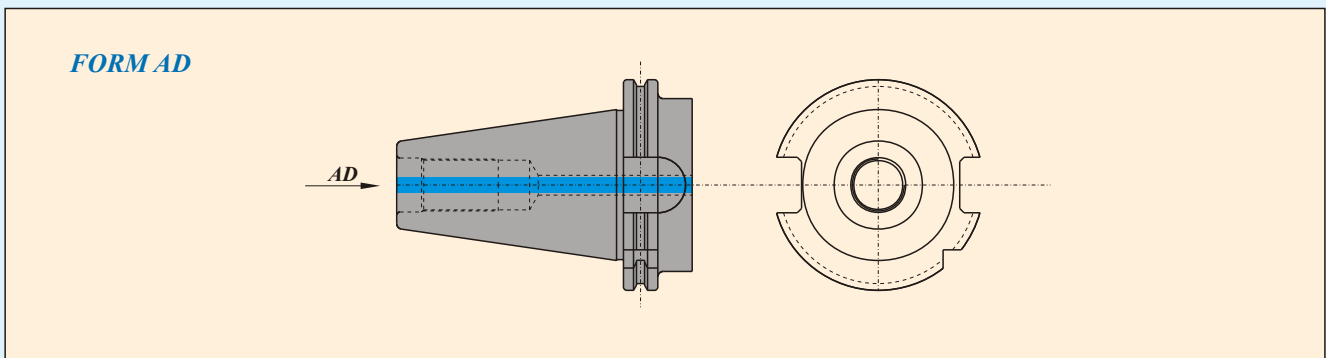

WITH COOLANT THROUGH FLANGE (FORM B)

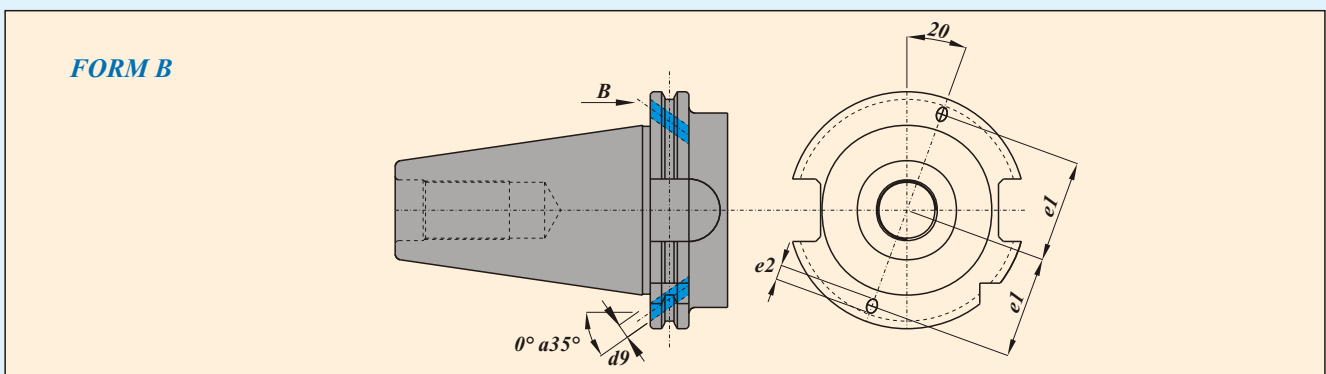

TAPER	d9	e1	e2
40	4	27	5
45	5	35	6
50	6	42	7

SIDE LOCK ADAPTER FOR STRAIGHT SHANK TOOLS

CT DIN 69871

Taper Angle Class AT3
Maximum runout of the
internal ID in relation
to the external taper 0.005 mm

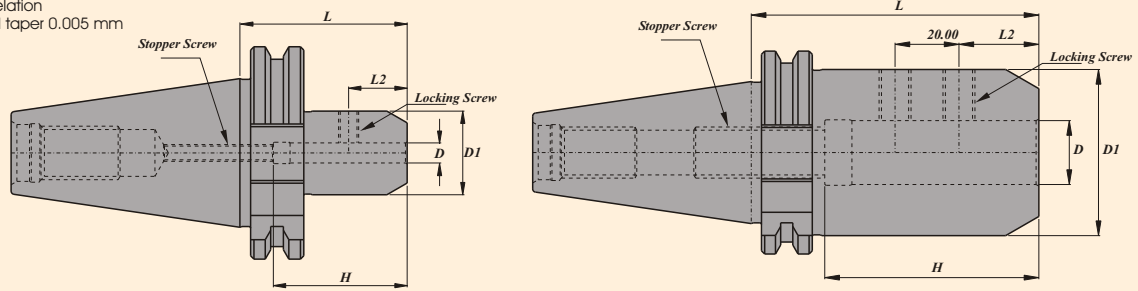

Description	CT	D	L	D1	L2	H	Stopper Screw	Locking Screw	Quantity
CT30SLA06065	30	6	65	20	15	40	M 5	M 6	1
CT30SLA08065	30	8	65	24	15	40	M 6	M 8	1
CT30SLA10065	30	10	65	30	16	44	M 8	M 10	1
CT30SLA12065	30	12	65	35	20	44	M 10	M 10	1
CT30SLA16065	30	16	65	40	23	52	M 12	M 10	1
CT30SLA20090	30	20	90	50	25	70	M 16	M 10	2
CT30SLA25090	30	25	90	50	25	70	M 20	M 10	2
CT40SLA06065	40	6	65	20	15	40	M 5	M 6	1
CT40SLA08065	40	8	65	24	15	40	M 6	M 8	1
CT40SLA10065	40	10	65	30	16	44	M 8	M 10	1
CT40SLA12065	40	12	65	35	20	44	M 10	M 10	1
CT40SLA16065	40	16	65	40	23	52	M 12	M 10	1
CT40SLA20090	40	20	90	50	25	70	M 16	M 10	2
CT40SLA25090	40	25	90	50	25	70	M 20	M 10	2
CT40SLA32090	40	32	90	60	30	70	M 20	M 10	2
CT40SLA40090	40	40	90	60	30	70	M 20	M 10	2
CT50SLA06075	50	6	75	20	15	40	M 5	M 6	1
CT50SLA08075	50	8	75	24	15	40	M 6	M 8	1
CT50SLA10075	50	10	75	30	16	44	M 8	M 10	1
CT50SLA12075	50	12	75	35	20	44	M 10	M 10	1
CT50SLA16075	50	16	75	40	23	52	M 12	M 10	1
CT50SLA20105	50	20	105	50	25	70	M 16	M 10	2
CT50SLA25105	50	25	105	50	25	70	M 20	M 10	2
CT50SLA32105	50	32	105	60	30	70	M 20	M 10	2
CT50SLA40105	50	40	105	60	30	70	M 20	M 10	2

Ordering Example :-
KTA CT40SLA06065 / Qty.- 2 Nos.

SIDE LOCK ADAPTOR WELDON TYPE

CT DIN 69871 DIN1835E

Taper Angle Class AT3
Maximum runout of the
internal ID in relation
to the external taper 0.005 mm

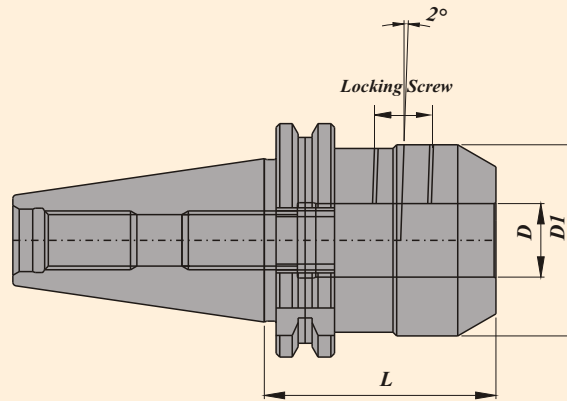

Description	ISO	D	L	D1	Locking Screw	Quantity	Stopper screw
CT30WN06045	30	6	45	25	M6	1	M5
CT30WN08045	30	8	45	28	M8	1	M6
CT30WN10050	30	10	50	35	M10	1	M8
CT30WN12050	30	12	50	42	M12	1	M10
CT30WN16063	30	16	63	48	M14	1	M12
CT30WN20063	30	20	63	52	M16	1	M16
CT40WN06050	40	6	50	25	M6	1	M5
CT40WN08050	40	8	50	28	M8	1	M6
CT40WN10050	40	10	50	35	M10	1	M8
CT40WN12050	40	12	50	42	M12	1	M10
CT40WN16063	40	16	63	48	M14	1	M12
CT40WN20063	40	20	63	50	M16	1	M16
CT40WN25100	40	25	100	65	M18 X 2	2	M20
CT40WN32100	40	32	100	72	M20 X 2	2	M20
CT50WN06050	50	6	50	25	M6	1	M5
CT50WN08050	50	8	50	28	M8	1	M6
CT50WN10050	50	10	63	35	M10	1	M8
CT50WN12063	50	12	63	42	M12	1	M10
CT50WN16063	50	16	63	48	M14	1	M12
CT50WN20063	50	20	63	52	M16	1	M16
CT50WN25080	50	25	80	65	M18 X 2	2	M20
CT50WN32085	50	32	85	72	M20 X 2	2	M20
CT50WN40095	50	40	95	78	M 20 X 2	2	M20

Ordering Example :-
KTA CT50WN40095 Qty.- 2 Nos.

HOLDERS ALSO AVAILABLE IN DIN 1835B

COMBI SHELL MILL ADAPTORS

CT DIN 69871
DIN 6358

Taper Angle Class AT3

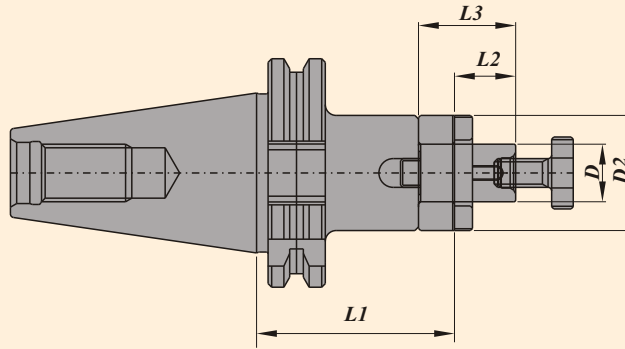

Description	ISO	D	L1	L2	L3	D2
CT30CSMA16050	30	16	50	17	27	32
CT30CSMA22050	30	22	50	19	31	40
CT30CSMA27055	30	27	55	21	33	48
CT40CSMA16055	40	16	55	17	27	32
CT40CSMA22055	40	22	55	19	31	40
CT40CSMA27055	40	27	55	21	33	48
CT40CSMA32060	40	32	60	24	38	58
CT40CSMA40060	40	40	60	27	41	70
CT50CSMA16065	50	16	65	17	27	32
CT50CSMA22065	50	22	65	19	31	40
CT50CSMA27065	50	27	65	21	33	48
CT50CSMA32080	50	32	80	24	38	58
CT50CSMA40080	50	40	80	27	41	70

Ordering Example :-
KTA CT40CSMA16055 / Qty.- 2 Nos.

COMBI SHELL MILL ADAPTORS (EXTRA LONG)

CT DIN 69871
DIN 6358

Taper Angle Class AT3

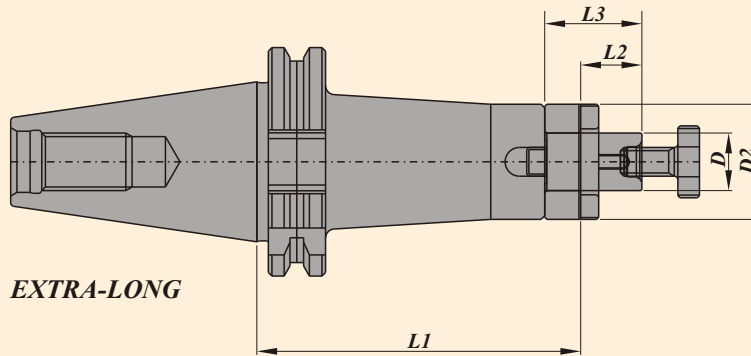

Description	ISO	D	L1	L2	L3	D2
CT40CSMA16090	40	16	100	17	27	32
CT40CSMA22090	40	22	100	19	31	40
CT40CSMA27090	40	27	100	21	33	48
CT40CSMA32100	40	32	100	24	38	58
CT50CSMA16100	50	16	100	17	27	32
CT50CSMA22100	50	22	100	19	31	40
CT50CSMA27100	50	27	100	21	33	48
CT50CSMA32100	50	32	100	24	38	58
CT50CSMA40100	50	40	100	27	41	70

Driver Ring	Screw	Key	D	Driver Ring	Screw	Key W□ X L
			16	DR16 X 10	SCR16 X M8	KEY 4□X20
			22	DR22 X 12	SCR22 X M10	KEY 6□X25
			27	DR27 X 12	SCR27 X M12	KEY 7□X25
			32	DR32 X 14	SCR32 X M16	KEY 8□X30
			40	DR40 X 14	SCR40 X M20	KEY 10□X30

Ordering Example :-
KTA CT50CSMA40100 / Qty.- 2 Nos.

FACE MILL HOLDERS TENNON DRIVER

CT DIN 69871
DIN 3937

Taper Angle Class AT3

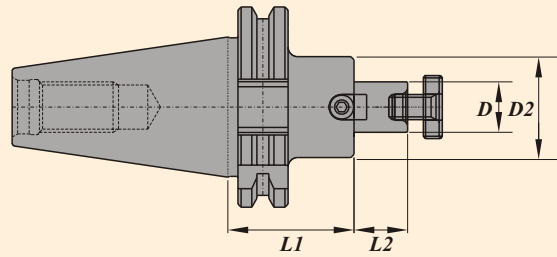

Description	ISO	D	L1	L2	D2
CT30FMH16040	30	16	40	17	38
CT30FMH22040	30	22	40	19	48
CT30FMH27040	30	27	40	21	58
CT40FMH16045	40	16	45	17	38
CT40FMH22045	40	22	45	19	48
CT40FMH27045	40	27	45	21	58
CT40FMH32050	40	32	50	24	78
CT40FMH40050	40	40	50	27	82
CT50FMH16055	50	16	55	17	38
CT50FMH22055	50	22	55	19	48
CT50FMH27055	50	27	55	21	58
CT50FMH32060	50	32	60	24	78
CT50FMH40060	50	40	60	27	82

Ordering Example :-
KTA CT50FMH40055 Qty.- 2 Nos.

FACE MILL HOLDERS TENNON DRIVER (EXTRA LONG)

CT DIN 69871
DIN 3937

Taper Angle Class AT3

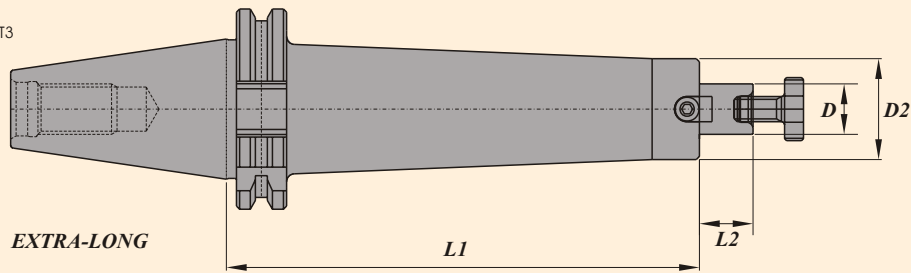

Description	ISO	D	L1	L2	D2
CT40FMH16120	40	16	120	17	38
CT40FMH22120	40	22	120	19	48
CT40FMH27120	40	27	120	21	58
CT40FMH32120	40	32	120	24	78
CT50FMH16150	50	16	150	17	38
CT50FMH22150	50	22	150	19	48
CT50FMH27150	50	27	150	21	58
CT50FMH32150	50	32	150	24	78
CT50FMH40150	50	40	150	27	82

Screw	Tennon	Allen Cap Screw	D	Screw	Tennon	Allen Cap Screw
			16	SCR16 X M8	8	M4
			22	SCR22 X M10	10	M5
			27	SCR27 X M12	12	M5
			32	SCR32 X M16	14	M6
			40	SCR40 X M20	16	M6

Ordering Example :-
KTA CT50FMH40150 Qty.- 2 Nos.

MORSE TAPER ADAPTORS

**CT DIN 69871
DIN 228-2 FORM D**

Taper Angle Class AT3
Maximum runout of the
internal taper in relation
to the external taper 0.005 mm

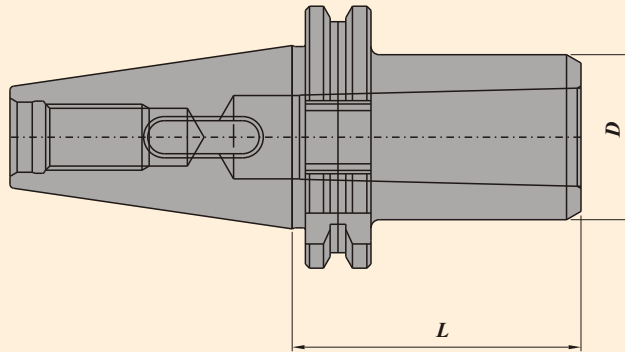

Description	ISO	MORSE	D	L
CT30MTA01050	30	1	25	50
CT30MTA02060	30	2	32	60
CT30MTA03075	30	3	40	75
CT40MTA01050	40	1	25	50
CT40MTA02050	40	2	32	50
CT40MTA03070	40	3	40	70
CT40MTA04095	40	4	48	95
CT50MTA01050	50	1	25	50
CT50MTA02060	50	2	32	60
CT50MTA03065	50	3	40	65
CT50MTA04095	50	4	48	95
CT50MTA05120	50	5	63	120

Ordering Example :-
KTA CT50MTA05120 Qty.- 2 Nos.

MORSE TAPER ADAPTORS (EXTRA LONG)

**CT DIN 69871
DIN 228-2 FORM D**

Taper Angle Class AT3
Maximum runout of the
internal taper in relation
to the external taper 0.005 mm

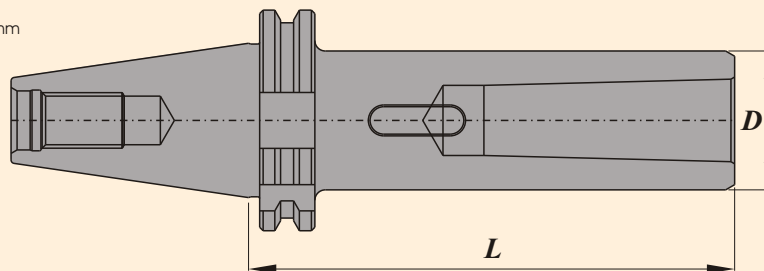

Description	ISO	MORSE	D	L
CT30MTA01110	30	1	25	110
CT30MTA02120	30	2	32	120
CT30MTA03140	30	3	40	140
CT40MTA01115	40	1	25	115
CT40MTA02125	40	2	32	125
CT40MTA03140	40	3	40	140
CT40MTA01120	50	1	25	120
CT50MTA02140	50	2	32	140
CT50MTA03150	50	3	40	150
CT50MTA04180	50	4	48	180
CT50MTA05220	50	5	63	220

Ordering Example :-
KTA CT50MTA05220 Qty.- 2 Nos.

CT SHANK 'ER' COLLET HOLDERS

CT A/ER DIN 69871

Taper Angle Class AT3
Maximum runout of the
internal taper in relation
to the external taper 0.005 mm

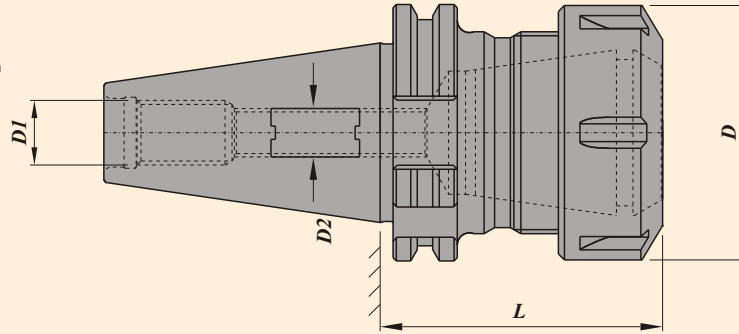

Collet Chuck Designation	Suitable for Collet	Collet Clamping Capacity	L	D1	D2	Nut		Spanner Designation
						D	Designation	
CT 30 ER 16060	ER 16	0.5 - 10	60	M 12	M 10	28	UM/ER 16	GS 25
CT 30 ER 16100	ER 16	0.5 - 10	100	M 12	M 10	28	UM/ER 16	GS 25
CT 30 ER 20060	ER 20	1.0 - 13	60	M 12	M 10	34	UM/ER 20	E 20
CT 30 ER 20100	ER 20	1.0 - 13	100	M 12	M 10	34	UM/ER 20	E 20
CT 30 ER 25060	ER 25	1.0 - 16	60	M 12	M 12	42	UM/ER 25	E 25
CT 30 ER 25100	ER 25	1.0 - 16	100	M 12	M 12	42	UM/ER 25	E 25
CT 30 ER 32060	ER 32	2.0 - 20	60	M 12	M 12	50	UM/ER 32	E 32
CT 30 ER 32100	ER 32	2.0 - 20	100	M 12	M 12	50	UM/ER 32	E 32
CT 30 ER 40100	ER 40	3.0 - 26	100	M 12	M 16	63	UM/ER 40	E 40
CT 40 ER 16060	ER 16	0.5 - 10	60	M 16	M 10	28	UM/ER 16	GS 25
CBT 40 ER 16100	ER 16	0.5 - 10	100	M 16	M 10	28	UM/ER 16	GS 25
CT 40 ER 16160	ER 16	0.5 - 10	160	M 16	M 10	28	UM/ER 16	GS 25
CT 40 ER 20060	ER 20	1.0 - 13	60	M 16	M 10	34	UM/ER 20	E 20
CT 40 ER 20100	ER 20	1.0 - 13	100	M 16	M 10	34	UM/ER 20	E 20
CT 40 ER 20160	ER 20	1.0 - 13	160	M 16	M 10	34	UM/ER 20	E 20
CT 40 ER 25060	ER 25	1.0 - 16	60	M 16	M 12	42	UM/ER 25	E 25
CT 40 ER 25100	ER 25	1.0 - 16	100	M 16	M 12	42	UM/ER 25	E 25
CT 40 ER 25160	ER 25	1.0 - 16	160	M 16	M 12	42	UM/ER 25	E 25
CT 40 ER 32070	ER 32	2.0 - 20	70	M 16	M 12	50	UM/ER 32	E 32
CT 40 ER 32100	ER 32	2.0 - 20	100	M 16	M 12	50	UM/ER 32	E 32
CT 40 ER 32160	ER 32	2.0 - 20	160	M 16	M 12	50	UM/ER 32	E 32
CT 40 ER 40080	ER 40	3.0 - 26	80	M 16	M 16	63	UM/ER 40	E 40
CT 40 ER 40100	ER 40	3.0 - 26	100	M 16	M 16	63	UM/ER 40	E 40
CT 40 ER 40160	ER 40	3.0 - 26	160	M 16	M 16	63	UM/ER 40	E 40
CT 50 ER 25065	ER 25	1.0 - 16	65	M 24	M 12	42	UM/ER 25	E 25
CT 50 ER 25100	ER 25	1.0 - 16	100	M 24	M 12	42	UM/ER 25	E 25
CT 50 ER 25160	ER 25	1.0 - 16	160	M 24	M 12	42	UM/ER 25	E 25
CT 50 ER 32070	ER 32	2.0 - 20	70	M 24	M 12	50	UM/ER 32	E 32
CT 50 ER 32100	ER 32	2.0 - 20	100	M 24	M 12	50	UM/ER 32	E 32
CT 50 ER 32160	ER 32	2.0 - 20	160	M 24	M 12	50	UM/ER 32	E 32
CT 50 ER 40080	ER 40	3.0 - 26	80	M 24	M 16	63	UM/ER 40	E 40
CT 50 ER 40100	ER 40	3.0 - 20	100	M 24	M 16	63	UM/ER 40	E 40
CT 50 ER 40160	ER 40	3.0 - 20	160	M 24	M 16	63	UM/ER 40	E 40
CT 50 ER 50100	ER 50	10.0 - 34	100	M 24	M 16	78	UM/ER 50	E 50
CT 50 ER 50160	ER 50	10.0 - 34	160	M 24	M 16	78	UM/ER 50	E 50

Ordering Example :-
KTA BT 40 ER 16100 / Qty.- 2 Nos.

For Ball Bearing Nut (KM/ER)
refer page no. 55,56

CT SHANK COLLET HOLDER (EXTRA LONG) WITH 'M' NUTS

**CTA/ER M
DIN 69871**

Taper Angle Class AT3
Maximum runout of the
internal taper in relation
to the external taper 0.005 mm

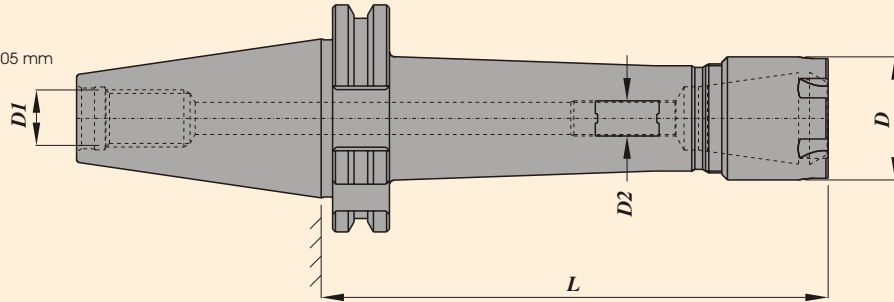

Collet Chuck Designation	Suitable for Collet	Collet Clamping Capacity	L	D1	D2	Nut		Spanner Designation
						D	Designation	
CT 40 ER 16M060	ER 16	0.5 - 10	60	M 16	M10	22	ER 16 M	E 16 M
CT 40 ER 16M120	ER 16	0.5 - 10	120	M 16	M10	22	ER 16 M	E 16 M
CT 40 ER 16M160	ER 16	0.5 - 10	160	M 16	M10	22	ER 16 M	E 16 M
CT 40 ER 20M060	ER 20	1.0 - 13	60	M 16	M10	28	ER 20 M	E 20 M
CT 40 ER 20M120	ER 20	1.0 - 13	120	M 16	M10	28	ER 20 M	E 20 M
CT 40 ER 20M160	ER 20	1.0 - 13	160	M 16	M10	28	ER 20 M	E 20 M
CT 40 ER 25M060	ER 25	1.0 - 16	70	M 16	M12	35	ER 25 M	E 25 M
CT 40 ER 25M120	ER 25	1.0 - 16	120	M 16	M12	35	ER 25 M	E 25 M
CT 40 ER 25M160	ER 25	1.0 - 16	160	M 16	M12	35	ER 25 M	E 25 M

Ordering Example :-
KTA CT 40 ER 25M160/ Qty. - 3 Nos.

For 'ER/M' Nut
refer page no. 55,56

ARBOR

**CT 69871
DIN 238**

Taper Angle Class AT3
Concentricity of external tapers
is within 0.005 mm

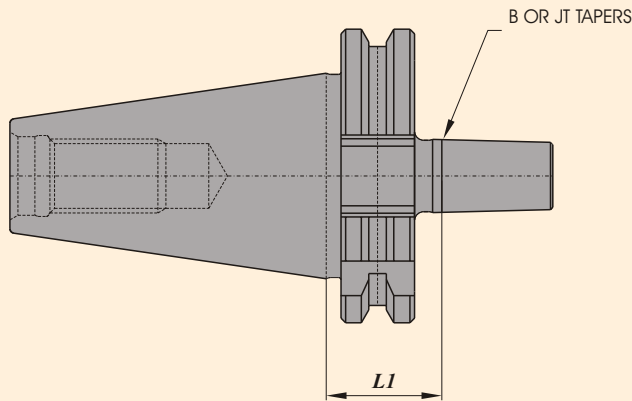

Description	ISO	B	L1
CT40J6	40	J6	27.5
CT40B12	40	B12	27.5
CT40B16	40	B16	27.5
CT50J6	50	J6	27.5
CT50B12	50	B12	27.5
CT50B16	50	B16	27.56

Ordering Example :-
KTA CT40B16027.5 Centre / Qty.- 2 Nos.

CT SHANK NC DRILL CHUCK

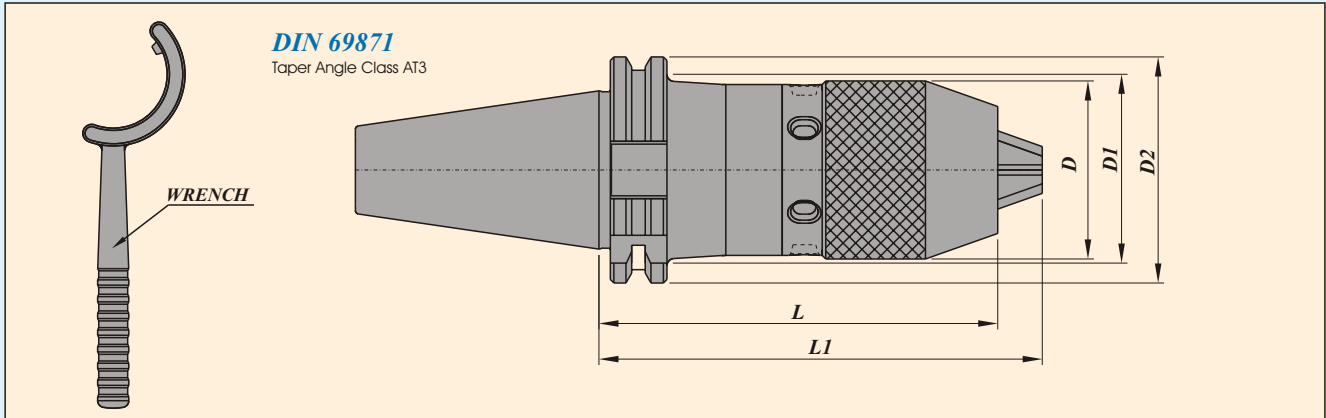

Type	D Ø	D1 Ø	D2 Ø	L	L1
CT40XDC113	50	54	63.5	112	124.5
CT45XDC113	50	57	82.5	95.5	108
CT50XDC113	50	59	97.5	103.5	116

Ordering Example :-
KTA CT50XDC113 / Qty.- 2 Nos.

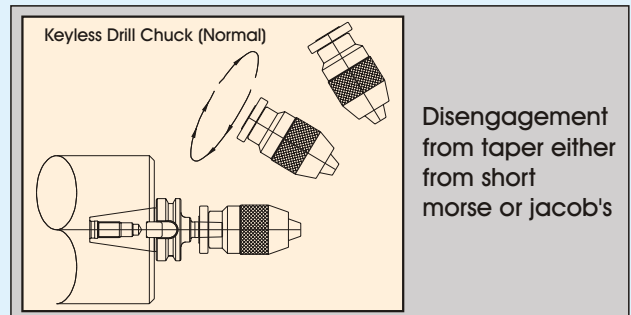
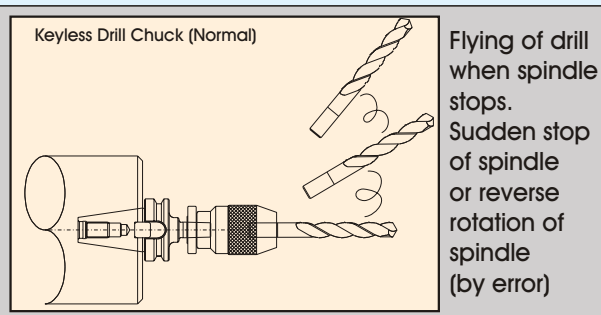
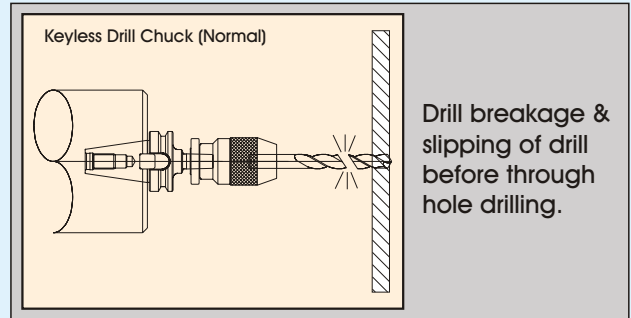
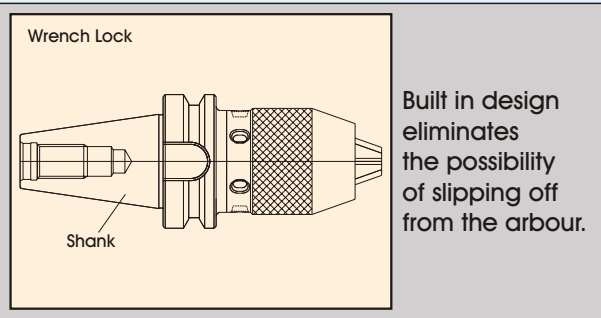

3 Times Chucking Power

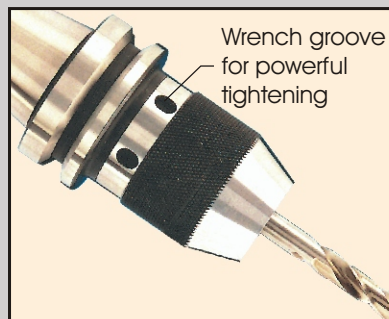
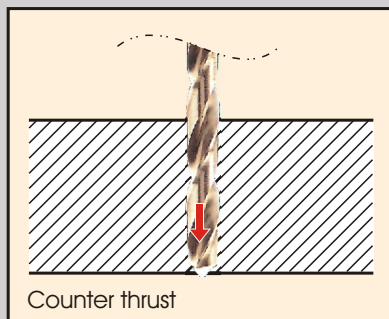

Comparison data of drill chuck tightening torque

Type of drill chuck	Method of tightening	Twisting moment	Comparison %
KTA DC 113	By hand	6.9 Nm	100
KTA NC DC 113	By wrench	21.8 Nm	300

Concentricity 0.04 T.I.R.

KWFLK / CAT / DIN 69871 : TAPPING CHUCK

CT DIN 69871

Taper Angle Class AT3

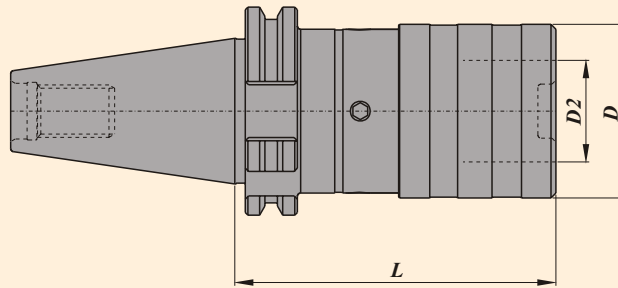

Chuck Designation Size	For Taps Size	Suitable Adaptors	Length Comp.		D dia.	D2 dia.	CT30 L	CT40 L	CT45 L	CT50 L
			Compr.	Expan.						
KWFLK1/CT	M 3 - M 12	KWES1B / KWE1	7.50	7.50	36	19	64.0	60.0	60.0	60.0
KWFLK2/CT	M 8 - M 20	KWES2B / KWE2	12.50	12.50	53	31	-	98.0	84.0	84.0
KWFLK3/CT	M 14 - M 33	KWES3B / KWE3	20.00	20.00	78	48	-	150.0	146.0	139.0

Ordering Example :-
KTA KWFLK3/CT / Qty.- 2 Nos.

For Adaptors refer
page no. 13,14,15

KWFLK / CAT / DIN 69871 (EXTRA LONG SPECIAL) : TAPPING CHUCK

CT DIN 69871

Taper Angle Class AT3

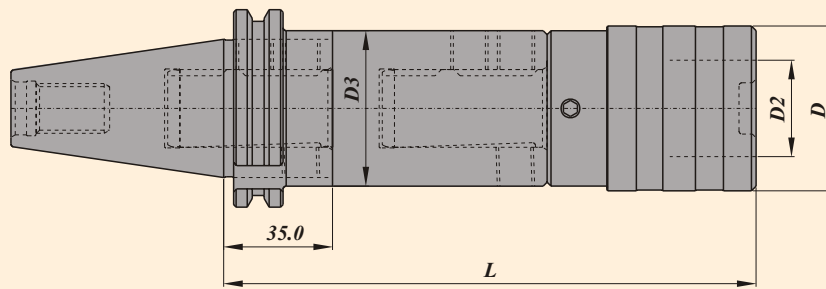

Chuck Designation Size	For Taps Size	Suitable Adaptors	Length Comp.		D dia.	D2 dia.	D3 dia.	CT40/L L	CT45/L L	CT50/L L
			Compr.	Expan.						
KWFLK1/CT	M 3 - M 12	KWES1B / KWE1	7.50	7.50	36	19	50	150 to 500	150 to 500	150 to 500
KWFLK2/CT	M 8 - M 20	KWES2B / KWE2	12.50	12.50	53	31	85	150 to 500	150 to 500	150 to 500
KWFLK3/CT	M 14 - M 33	KWES3B / KWE3	20.00	20.00	78	48	100	200 to 500	200 to 500	200 to 500

Ordering Example :-
KTA KWFLK3/CT / Qty.- 2 Nos.

For Adaptors refer
page no.13,14,15

RIGID TAPPING CHUCK Q / CT40 : TAPPING CHUCK

CT DIN 69871

Taper Angle Class AT3

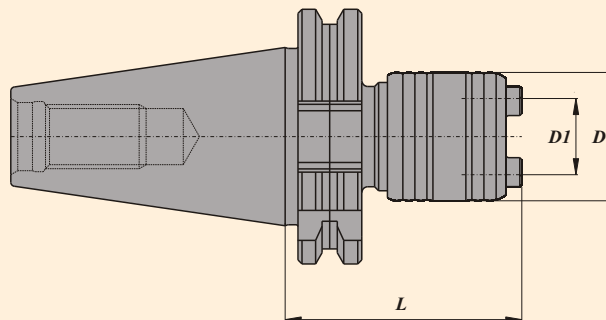

Chuck Designation	Capacity	Suitable Adaptors KWE & KWES B Size	D	D1	30	40	50
					L	L	L
Q 3-12 / CT	M3 - M12	KWE1/ KWES1B	32	19	59	59	59
Q 8-20 / CT	M8 - M20	KWE2/ KWES2B	50	31	82	82	82

Ordering Example :-
KTA Q 3-12 / CT40 / Qty.- 2 Nos.

For Adaptors refer
page no. 13,14,15

HEX DRIVE NEW RIGID TAPPING SYSTEM

HEX DRIVE CT SHANK ER/TC RIGID TAPPING CHUCK

TECHNICAL INFORMATION ON HEX DRIVE

It is the most Universal Rigid Tapping Chuck. There is a Hexagon provided inside the main collet chuck and there is outside Hexagon provided for Rigid Tapping adaptor.

After inserting the Hex Drive Tap Adaptor inside the holder, it becomes most positive driving Mechanism.

Secondly there is a square & diameter provided in the Rigid Tap Adaptor, which holds the Tap firmly & because of square drive, the tap is driven positively, without any slippage.

The biggest advantage is quick changing of the tap, just press the bush & remove the tap & insert the new tap with same geometry & start the machine.

HEX DRIVE CT SHANK ER/TC RIGID TAPPING CHUCK

TC B / ER
DIN 69871

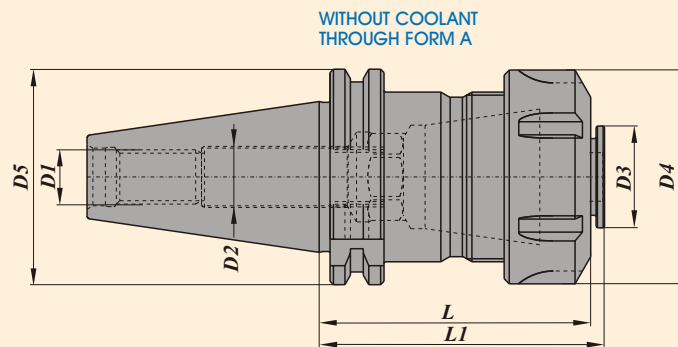

Collet Chuck Designation	Suitable TAP Collet	Tap Clamping Capacity	Tap Holding Range upto	D1	D2	D3	D5	L	L1	Nut		Spanner Designation
										D4	Designation	
HEX DRIVE TC 30 A ER 32070	ER 32 / TC1	M3 - M 12	Ø 12 x □ 9 mm	M 12	M12	18	50	70	74	50	UM/ER 32	E 32
HEX DRIVE TC 40 A ER 32070	ER 32 / TC1	M3 - M 12	Ø 12 x □ 9 mm	M 16	M12	18	63.55	70	74	50	UM/ER 32	E 32
HEX DRIVE TC 40 A ER 40080	ER 40 / TC2	M8 - M 20	Ø 16 x □ 12.5 mm	M 16	M16	30	63.55	70	74	63	UM/ER 40	E 40
HEX DRIVE TC 50 A ER 32100	ER 32 / TC1	M3 - M 12	Ø 12 x □ 9 mm	M 24	M12	18	97.5	100	104	50	UM/ER 32	E 32
HEX DRIVE TC 50 A ER 40100	ER 40 / TC2	M8 - M 20	Ø 16 x □ 12.5 mm	M 24	M16	30	97.5	100	104	63	UM/ER 40	E 40

Ordering Example :-
KTA HEX DRIVE TC 30 A ER 32 Without coolant / Qty. - 2 Nos.

For Ball Bearing Nut (KM/ER)
refer page no. 55 ,56

HEX DRIVE ER/TC RIGID TAPPING COLLET

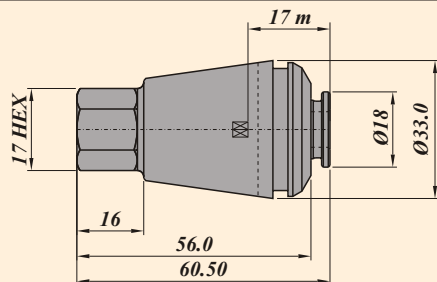

ER32/TC1 M3 TO M12
SPECIFY SHANK & SQUARE SIZE WHILE ORDERING
FOR EXAMPLE 9.0 X 7.1 SQ.

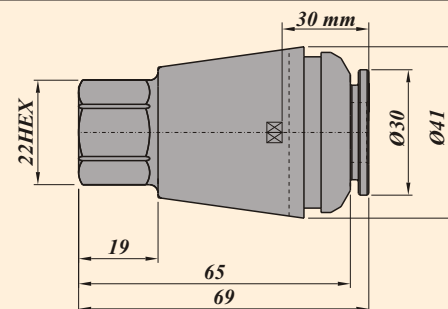

ER40/TC2 M8 TO M20
SPECIFY SHANK & SQUARE SIZE WHILE ORDERING
FOR EXAMPLE 11.2 X 9.0 SQ.

FOR TAP ADAPTOR DETAILS REFER PAGE NO. 13

HEX DRIVE NEW RIGID TAPPING SYSTEM

HEX DRIVE CT SHANK ER/TC RIGID TAPPING CHUCK

TECHNICAL INFORMATION ON HEX DRIVE

It is the most Universal Rigid Tapping Chuck. There is a Hexagon provided inside the main collet chuck and there is outside Hexagon provided for Rigid Tapping adaptor.

After inserting the Hex Drive Tap Adaptor inside the holder, it becomes most positive driving Mechanism.

Secondly there is a square & diameter provided in the Rigid Tap Adaptor, which holds the Tap firmly & because of square drive, the tap is driven positively, without any slippage.

The biggest advantage is quick changing of the tap, just press the bush & remove the tap & insert the new tap with same geometry & start the machine.

HEX DRIVE CT SHANK ER/TC RIGID TAPPING CHUCK

TC B / ER
DIN 69871

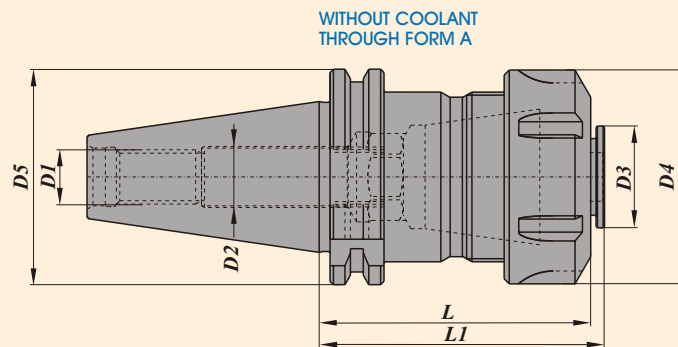

Collet Chuck Designation	Suitable TAP Collet	Tap Clamping Capacity	Tap Holding Range upto	D1	D2	D3	D5	L	L1	Nut		Spanner Designation
										D4	Designation	
HEX DRIVE TC 30 A ER 32070	ER 32 / TC1	M3 - M 12	Ø 12 x □ 9 mm	M 12	M12	18	50	70	74	50	UM/ER 32	E 32
HEX DRIVE TC 40 A ER 32070	ER 32 / TC1	M3 - M 12	Ø 12 x □ 9 mm	M 16	M12	18	63.55	70	74	50	UM/ER 32	E 32
HEX DRIVE TC 40 A ER 40080	ER 40 / TC2	M8 - M 20	Ø 16 x □ 12.5 mm	M 16	M16	30	63.55	70	74	63	UM/ER 40	E 40
HEX DRIVE TC 50 A ER 32100	ER 32 / TC1	M3 - M 12	Ø 12 x □ 9 mm	M 24	M12	18	97.5	100	104	50	UM/ER 32	E 32
HEX DRIVE TC 50 A ER 40100	ER 40 / TC2	M8 - M 20	Ø 16 x □ 12.5 mm	M 24	M16	30	97.5	100	104	63	UM/ER 40	E 40

Ordering Example :-
KTA HEX DRIVE TC 30 A ER 32 Without coolant / Qty. - 2 Nos.

For Ball Bearing Nut (KM/ER)
refer page no. 55 ,56

HEX DRIVE ER/TC RIGID TAPPING COLLET

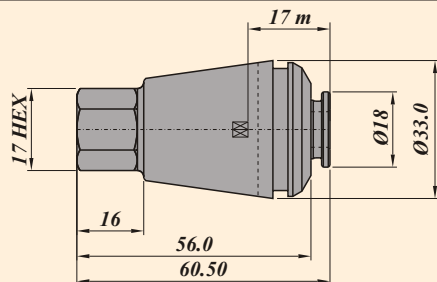

ER32/TC1 M3 TO M12
SPECIFY SHANK & SQUARE SIZE WHILE ORDERING
FOR EXAMPLE 9.0 X 7.1 SQ.

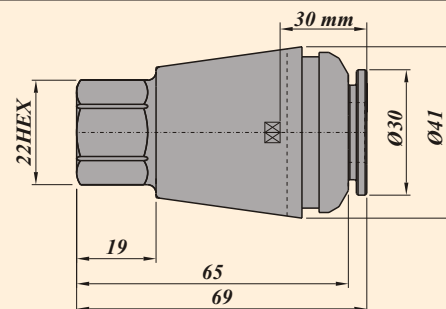

ER40/TC2 M8 TO M20
SPECIFY SHANK & SQUARE SIZE WHILE ORDERING
FOR EXAMPLE 11.2 X 9.0 SQ.

FOR TAP ADAPTOR DETAILS REFER PAGE NO. 13

CT FLOATING REAMER HOLDER

CT DIN 69871

Taper Angle Class AT3

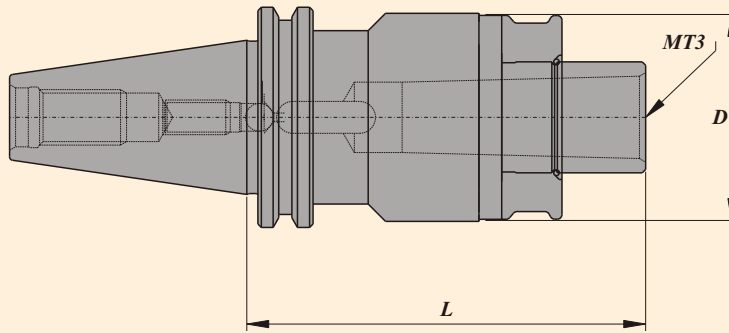

Collet Chuck Designation	L	D	Radial Parallel Float
CT 40 FRH / MT3	115	60	1.5
CT 50 FRH / MT3	86	60	1.5

MASTER MANDREL

CT DIN 69871

Taper Angle Class AT3

MASTER MANDRELS ACCORDING TO DIN 69871
RUNOUT MAX 0.005 TAPER w.r.t. PLANE DIA AT L

NOTE:-TO BE VERTICALLY STORED
SUPPLIED IN WOODEN BOX

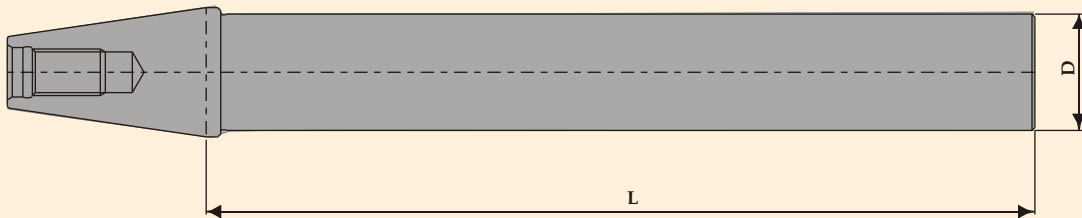

- CT30 DIN69871 ØD 32 L=250
- CT40 DIN69871 ØD 40 L=300
- CT50 DIN69871 ØD 50 L=350

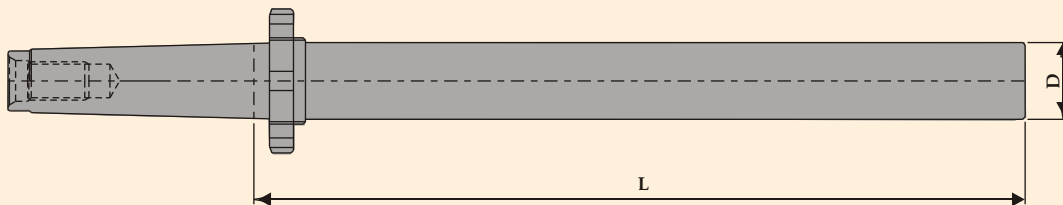

- MT2 ØD 24 L=150
- MT3 ØD 32 L=200
- MT4 ØD 40 L=300
- MT5 ØD 40 L=300

ER COLLET CHUCK

CT B / ER DIN 69871

Taper Angle Class AT3
Maximum runout of the
internal taper in relation
to the external taper 0.005 mm

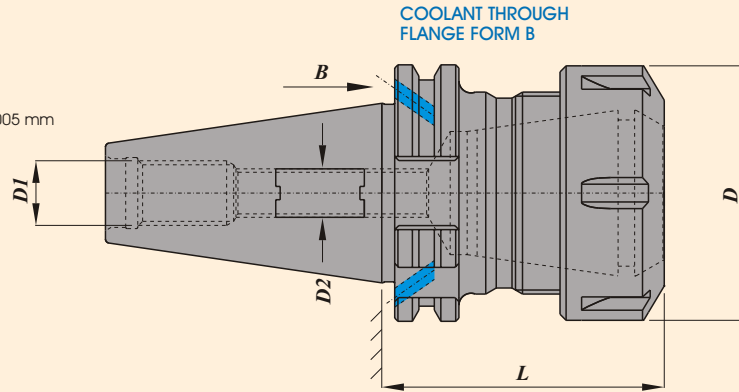

Collet Chuck Designation	Suitable for Collet	Collet Clamping Capacity	L	D1	D2	Nut Designation		Spanner Designation
						D		
CT 30 ER 16060ADB	ER 16	0.5 - 10	60	M 12	M 10	28	UM/ER 16	GS 25
CT 30 ER 16100ADB	ER 16	0.5 - 10	100	M 12	M 10	28	UM/ER 16	GS 25
CT 30 ER 20060ADB	ER 20	1.0 - 13	60	M 12	M 10	34	UM/ER 20	E 20
CT 30 ER 20100ADB	ER 20	1.0 - 13	100	M 12	M 10	34	UM/ER 20	E 20
CT 30 ER 25060ADB	ER 25	1.0 - 16	60	M 12	M 12	42	UM/ER 25	E 25
CT 30 ER 25100ADB	ER 25	1.0 - 16	100	M 12	M 12	42	UM/ER 25	E 25
CT 30 ER 32060ADB	ER 32	2.0 - 20	60	M 12	M 12	50	UM/ER 32	E 32
CT 30 ER 32100ADB	ER 32	2.0 - 20	100	M 12	M 12	50	UM/ER 32	E 32
CT 30 ER 40100ADB	ER 40	3.0 - 26	100	M 12	M 16	63	UM/ER 40	E 40
CT 40 ER 16060ADB	ER 16	0.5 - 10	60	M 16	M 10	28	UM/ER 16	GS 25
CT 40 ER 16100ADB	ER 16	0.5 - 10	100	M 16	M 10	28	UM/ER 16	GS 25
CT 40 ER 16160ADB	ER 16	0.5 - 10	160	M 16	M 10	28	UM/ER 16	GS 25
CT 40 ER 20060ADB	ER 20	1.0 - 13	60	M 16	M 10	34	UM/ER 20	E 20
CT 40 ER 20100ADB	ER 20	1.0 - 13	100	M 16	M 10	34	UM/ER 20	E 20
CT 40 ER 20160ADB	ER 20	1.0 - 13	160	M 16	M 10	34	UM/ER 20	E 20
CT 40 ER 25060ADB	ER 25	1.0 - 16	60	M 16	M 12	42	UM/ER 25	E 25
CT 40 ER 25100ADB	ER 25	1.0 - 16	100	M 16	M 12	42	UM/ER 25	E 25
CT 40 ER 25160ADB	ER 25	1.0 - 16	160	M 16	M 12	42	UM/ER 25	E 25
CT 40 ER 32070ADB	ER 32	2.0 - 20	70	M 16	M 12	50	UM/ER 32	E 32
CT 40 ER 32100ADB	ER 32	2.0 - 20	100	M 16	M 12	50	UM/ER 32	E 32
CT 40 ER 32160ADB	ER 32	2.0 - 20	160	M 16	M 12	50	UM/ER 32	E 32
CT 40 ER 40080ADB	ER 40	3.0 - 26	80	M 16	M 16	63	UM/ER 40	E 40
CT 40 ER 40100ADB	ER 40	3.0 - 26	100	M 16	M 16	63	UM/ER 40	E 40
CT 40 ER 40160ADB	ER 40	3.0 - 26	160	M 16	M 16	63	UM/ER 40	E 40
CT 50 ER 25065ADB	ER 25	1.0 - 16	65	M 24	M 12	42	UM/ER 25	E 25
CT 50 ER 25100ADB	ER 25	1.0 - 16	100	M 24	M 12	42	UM/ER 25	E 25
CT 50 ER 25160ADB	ER 25	1.0 - 16	160	M 24	M 12	42	UM/ER 25	E 25
CT 50 ER 32070ADB	ER 32	2.0 - 20	70	M 24	M 12	50	UM/ER 32	E 32
CT 50 ER 32100ADB	ER 32	2.0 - 20	100	M 24	M 12	50	UM/ER 32	E 32
CT 50 ER 32160ADB	ER 32	2.0 - 20	160	M 24	M 12	50	UM/ER 32	E 32
CT 50 ER 40080ADB	ER 40	3.0 - 26	80	M 24	M 16	63	UM/ER 40	E 40
CT 50 ER 40100ADB	ER 40	3.0 - 20	100	M 24	M 16	63	UM/ER 40	E 40
CT 50 ER 40160ADB	ER 40	3.0 - 20	160	M 24	M 16	63	UM/ER 40	E 40
CT 50 ER 50100ADB	ER 50	10.0 - 34	100	M 24	M 16	78	UM/ER 50	E 50
CT 50 ER 50160ADB	ER 50	10.0 - 34	160	M 24	M 16	78	UM/ER 50	E 50

Ordering Example :-
KTA BT 40 ER 16060 ADB / Qty.- 2 Nos.

For Ball Bearing Nut (KM/ER)
refer page no. 55 , 56